

Marteau à piquer les soudures manche frêne

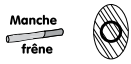

Polissage latéral, extrémités polies et angles arrondis

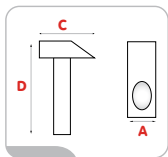

ΔT ⁰	A	C	D	Manche de rechange	Coins type rond
	mm	mm	mm		
140.2170	300	20	165	390	140.5304

Marteau à garnir manche frêne

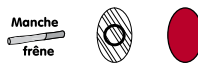

Polissage latéral, extrémités polies et angles arrondis

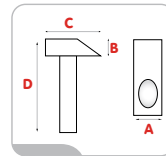

ΔT ⁰	A	B	C	D	Manche de rechange	Coins type rond
	mm	mm	mm	mm		
140.4003	400	30	30	118	310	140.5304

Marteau de coffreur manche frêne

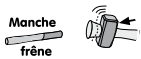

Polissage latéral, panne et pointe aiguisées, coins arrondis

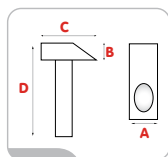

ΔT ⁰	A	B	C	D	Manche de rechange
	mm	mm	mm	mm	
142.2008	700	30	28	172	370

Marteau de coffreur manche tri-matière



Polissage latéral, extrémités polies et angles arrondis

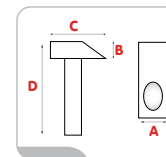

ΔT ⁰	A	B	C	D	Manche de rechange
	mm	mm	mm	mm	
142.2010	700	23	28	172	370